

Clay

keep it close



Intuitive.
Flexible.
Simply works.



“Clay is the
easy wireless
cloud-based
locking
solution”



ClayIQ



Clay Doorlock



Clay Cylinder



ClayTag



Clay Repeater



My-Clay.com



Clay App

Contents

- 1 Overview
- 2 Key Points
- 3 ClayIQ
- 4 Clay Doorlock
- 5 Clay Cylinder
- 6 ClayTag
- 7 Clay Repeater
- 8 Clay Wall Reader
- 9 My-Clay.com
- 10 Clay App
- 12 Extended Product Range

Clay

By SALTO

Clay by SALTO is the easy, secure cloud-based wireless locking solution for small and medium sized enterprises. Revolutionary in design, usability and features.

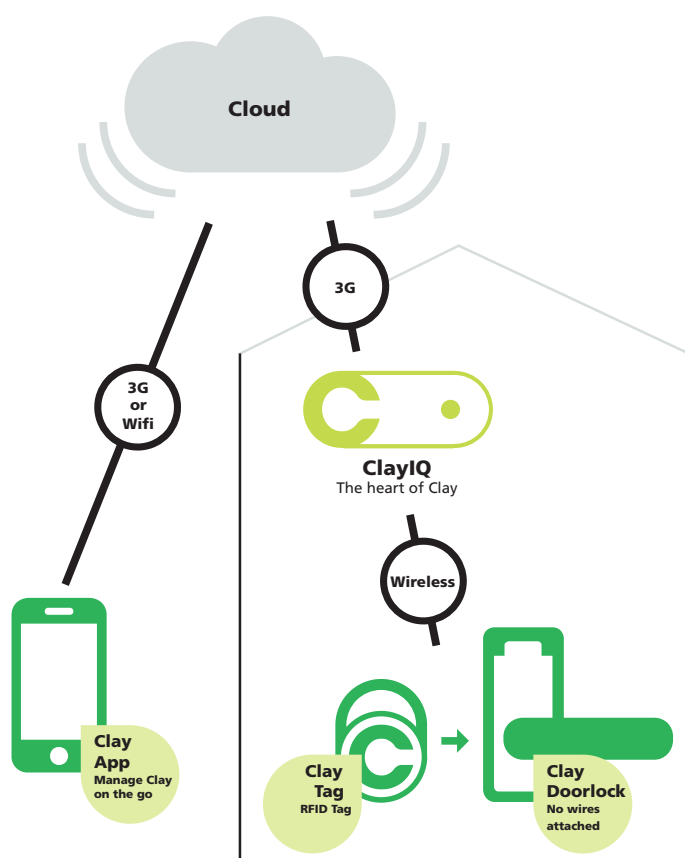

**Immediate access control
From everywhere
Truly wireless**

Clay is a cloud-based electronic locking solution for Small and Medium Sized Enterprises (SME) that greatly enhances users' flexibility in access management. Clay's real-time reporting to the clay app brings together control and convenience by combining an intuitive software platform with high-quality and well-designed hardware that is easy and quick to install. This is a ground-breaking product that brings wireless electronic access control to SMEs, providing vastly better functionality and performance than is possible in a traditional mechanical solution with a flexible management system that requires no software installation nor the cost of a fully-wired electronic product.



Key Points

- Maximum users 250.
- Clay IQ (main control unit) distance to lock 15m.
- Repeaters extend to 60m (3 repeaters).
- 16 Doors per clay IQ unit.
- Unlimited Clay IQ's per account.
- Annual 3G Data plan subscription, with free updates.
- Control doors & personal access from My-Clay management software.
- Manage on the go with Clay phone App.
- Extensible system with multiple locking options to suit your needs.



ClayIQ

The heart of Clay

The ClayIQ is the centre of the Clay Universe. It connects your wireless locks to the My-Clay cloud. Mount the ClayIQ with the included mount bracket, plug it into the power outlet and activate it in your My-Clay account.

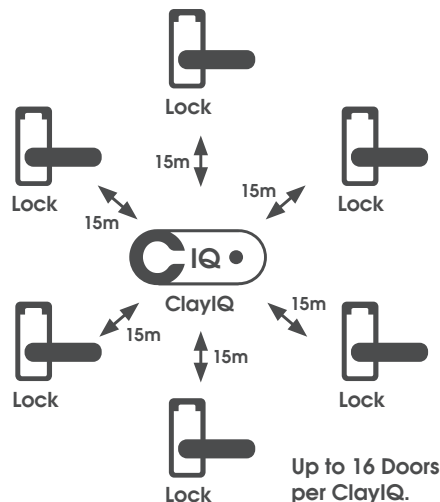

Plug and Clay

The ClayIQ finds its way into the cloud all by itself. 2 screws, a power socket and you're done.



It always fits

The ClayIQ bracket adapts to your situation. Mount it horizontally or vertically, whatever suits you best.



The ClayIQ has a heart

To let you know everything works fine the ClayIQ gives a green LED flash every 5 minutes.



Connectivity

The ClayIQ doesn't use Wifi but manages the internet connectivity by itself, using an integrated 3G sim to communicate. The rule of thumb is that wherever you can make a cellular phone call, you can install a ClayIQ. Maximum distance to the Clay locks and cylinders is 15 metres, but in case you need more you can extend the range with up to 3 Clay Repeaters, giving you up to 60 metres.



Remote locations

If you have a single remote door the ClayIQ is a great way to avoid major investments. Add an additional ClayIQ to your account and management of that single door is fully integrated in your My-Clay account.



No additional cost

All cost for the connectivity of the ClayIQ is covered within your selected 3G subscription plan, with no surprises.

Clay Doorlock

No wires attached

Clay Doorlocks fit every door, are battery operated and fully wireless. The locks come in different finishes and with several different handle sets to best match your building design.



 **KEYPRINT®**
SECURITY LTD



Sizes

The Clay Doorlock is specially designed to fit Euro and Scandinavian profile doors, even narrow profile framed doors. They work with the vast majority of European, Scandinavian and Swiss mortise locks and cylinders. The Clay Doorlock is IP55 compliant, so it can be fitted to exterior doors.



SALTO Quality

Clay is proud to be working with SALTO Systems hardware. SALTO is the selected access control option on over 1,500,000 doors, on more than 13,000 projects, in over 90 countries.



Finishes

SALTO offers a wide range of finishes to choose from, including PVD coating (Physical Vapor Deposition - providing superior oxidation and abrasion resistance) and RAL colours. Optionally BioCote® can be incorporated which gives products continuous, built-in antimicrobial protection, helping to prevent the growth of microbes including surface bacteria and mould by up to 99.99%.



Battery life

The batteries in the Clay Doorlock last for 40,000 openings. That's roughly 55 times a day for 2 years! And when they run low, your My-Clay admin account tells you straight away via SMS, email or Push Message (see page 9).
Narrow version: 3 Alkaline AAA 1.5v.
Wide version: 3 Alkaline AA 1.5v.
Lithium batteries can be used for harsh weather environments.



Instant Messaging

Clay Doorlocks are interactive. Sensors in the lock detect if a door is left open, or worse, when the door is opened without a valid credential. My-Clay.com lets the account administrator decide who receives what messages.



Always exit safe

No worries, even though the Clay Doorlock is electronic, from the inside it always allows escape in the event of an emergency. We call it the anti-panic function.

Keyprint Security Limited
45 Assembly Street Edinburgh EH6 7BQ UK
Tel: +44 (0)131 555 0909 Fax: +44 (0)131 555 0909
Email: sales@keyprint.co.uk
Website: www.keyprint.co.uk

Clay Cylinder

Small, fast, easy

The Clay range of electronic cylinders is compact in size, which makes them an ideal solution for almost any type of door where fitting a conventional electronic handle set is not possible or required.

SALTO
Quality



Installs in 5 minutes

Clay Cylinders install so fast that full installation of the Clay Cylinder + ClayIQ can be completed within 15 minutes. That's what we call easy!



Fully weatherproof

Clay Cylinders have an IP56 rating which means -20°C to +65°C, dust or rain, performance is not affected.



Battery life

The battery in the Clay Cylinder lasts for 40,000 openings. That's roughly 55 times a day for 2 years! And when they run low, My-Clay tells you straight away via SMS, email or Push Message. Each cylinder lock is powered by a CR2 battery.

KEYPRINT®
SECURITY LTD



Sizes

Clay Cylinder will be available for any type of door, including those with narrow frames. Mortise, Rim, Scandinavian or Padlock. Which are all supported with a choice of different cam and cylinder profiles: Euro and UK Oval profile, with all models available as double or half versions.



SALTO Quality

Clay is proud to be working with SALTO Systems hardware. SALTO is the selected access control option on over 1,500,000 doors, on more than 13,000 projects, in over 90 countries. Within 10 years, SALTO Systems has become a world market leader in wireless access control solutions.



Finishes

Available in 5 different finishes: satin chrome, polished chrome, PVD, polished brass, PVD satin brass, BioCote®.



Security

Panic function available. High security via high resistance, hardened anti-drill protection. Concealed fixing screws for greater security and improved aesthetics. Cylinders can be stamped. SKG*** compliant (Dutch Attack Resistance Standard).

ClayTag

Meet your new key

The Clay Tag is the smallest part of the Clay family but highly secure and just as good-looking. The heart of the tag holds the most secure RFID chip available in the market to make sure that it's impossible to duplicate the Tag ID.

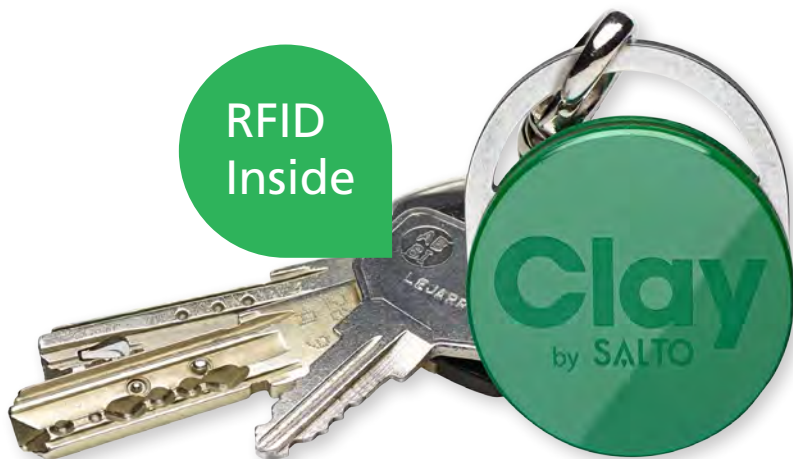

Adding Tags

To add tags you just select one of your doors via www.my-clay.com and use the secured 2 minute window to present them at the lock. Once added they are yours forever!



Blocking Tags

In case someone has lost or did not return one of your tags, you simply block them via your My-Clay account. Blocking is real-time without any delay and when you retrieve a tag you simply unblock it.



1 Tag but 5 colours

No one person is alike and Clay understands this. That's why the ClayTag will be available in 5 colours: Grey, White and 3 Greens!



No batteries

The ClayTag is a passive device meaning that it doesn't hold a battery. The power needed for communication comes from Clay Doorlock/Cylinder so the ClayTag never runs out of energy.



Security

You can add any ClayTag to your system but once they are added they will only work on the doors that you want them to work on. The RFID technology used is the same as in many governmental and military applications and uses an AES algorithm (Advanced Encryption Standard), providing the latest high security.

Clay Repeater

Extended possibilities

The Clay Repeater allows you to extend the distance between the ClayIQ and your locks. ClayIQ and locks can be 1–15 metres apart but each time you add a Clay Repeater you extend this by 15 metres. You may add up to 3 Repeaters in between a ClayIQ and a lock which means that the maximum distance between door and ClayIQ is 60 metres.

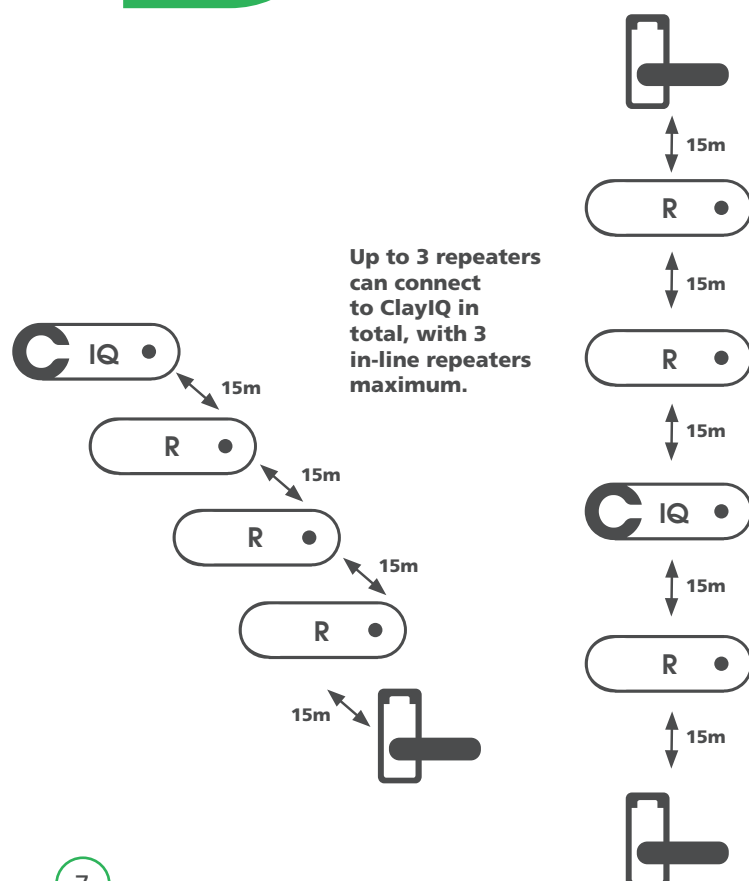

1, 2 or three

Add up to three Repeaters in between your lock and the ClayIQ.



Easy Set-Up

Like every component in your Clay system, the Repeater needs very little set-up.



Office move?

If you ever move offices and your ClayIQ and Clay Locks are a bit further apart, just add a Repeater and you are all set.



Wireless

As with all components in a Clay installation the Clay Repeater is fully wireless. The Clay Repeater comes with a Clay power adapter. Simply plug this in and that's it.

98743 Activation Code

To make sure that it's you who is adding a Clay Repeater, you enter your activation code in My-Clay.com. Clay sends you a SMS and when that matches, the Clay Repeater is connected to your account indefinitely.



LED

The Clay Repeater has the same intuitive LED notification as the ClayIQ. This means that besides through My-Clay messaging also a visual notification on the device itself will inform you about the well-being of your Clay system.

Wall Reader & Control Unit

Secure opening and locking for only the right people at the right times

Clay by Salto wall readers with control unit enable the expansion of SALTO access control benefits to all those doors where an electronic lock cannot be fitted i.e. barriers, elevators, mechanical doors etc, or where control must be boosted by an online real-time access control.



Wireless

As with all components in a Clay installation the Clay Control Unit is fully wireless, which comes with a Clay power adapter. Simply plug this into the power. The Clay Wall Reader is connected to the Control Unit through a standard UTP cable (Unshielded Twisted Pair). UTP cabling is used extensively for local-area networks (LANs) and telephone connections.



LED

The Clay Wall Reader includes a dual colour LED (green/red) to indicate access authorisation. This means that besides through My-Clay messaging also a visual notification on the device itself will inform about access or rejected ClayTag.



Outdoor

Clay Wall Reader have an IP66 protection rating, which means performance is not affected by dust, rain or temperatures ranging from -20°C to +80°C.

My-Clay.com

Lock management in the cloud

No software installation, scaling on any device, secured login, intuitive design, anything you may expect from today's cloud solution is in My-Clay.com. Manage locks, people, messages and access rights with no hassle.

In The Office



On The Sofa

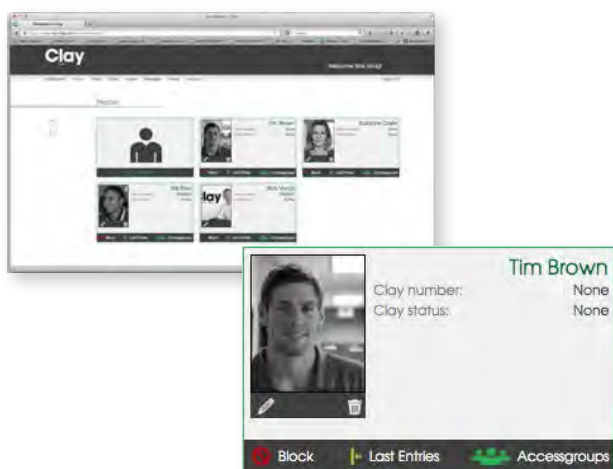

Security

Clay understands the importance of security. That's why we have incorporated state of the art security measures in all our components and more importantly: we will keep updating that permanently. Not always visible but always there.



Remote Opening

One of the cool but really functional features of Clay is the remote opening of doors with secure OneTimePassword technology. You may not use it every day but when you need it, you will be happy it's there.



Any device, any platform

My-Clay.com has been developed supporting all the latest browsers, devices and operating systems. From iOS to Windows and from laptop to Ipad.



The Dashboard

My-Clay.com always gives you up to date information and remote management of all Clay components through the dashboard. It's all there: Door status, last entries and events, alarms and the possibility to open and lock doors remotely.



Access rights, who, where, when...

What no conventional key can do is change access rights on the fly. My-Clay.com gives you the opportunity to individually determine who enters when and where. And if you want to change that, just log-in, make your changes and it's done. No updating of ClayTag or Clay Doorlock required. Have you ever been able to do this with your current lock?



Messaging

My-Clay.com offers you a message centre that allows you to self-configure messages. For instance: who entered when or a message letting you know that a door was left open. And any message can have its own recipients and 3 receiving device types: Email, SMS and App Push Messages.

Clay App

Manage Clay on the go

Available for iOS and Android Phones the Clay App enables you to manage your Clay system when you are on the go. It offers all those features that you need, whenever and wherever.



On The Go

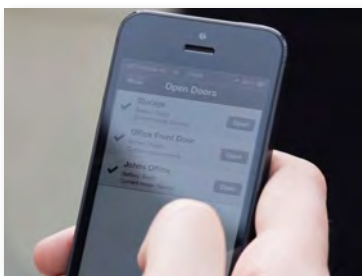

Blocking Tags

In case someone has lost or did not return one of your tags you simply block them via the Clay App. Blocking is real-time without any delay and when you retrieve a tag you simply unblock it.



Locking doors

You can set Clay doors in so-called office mode; meaning that during certain hours, doors are always unlocked. But when you have left and you are unsure whether your doors are out of that office mode, you don't want to worry too long. Use the Lock all Doors feature on the Clay App to lock all doors instantly.



Remote Opening

One of the cool but really functional features of the Clay App is the remote opening of doors with secure OneTimePassword technology. You may not use it every day but when you need it you will be happy it's there.



Download the Clay App

Available on Android and Apple mobile platforms.



Clay

keep it close

And now you will really be convinced

To show you the ease of installation and the most common features of Clay we shot a 2 minute video. Scan the QR-code with a mobile device and watch it!

KEEP IT CLOSE!

CLAY



Extensive Range

Of locking products and accessories available
Please contact us for the full range by phone on 0131 555 0909 or alternatively by email at sales@keyprint.co.uk





45 Assembly Street Edinburgh EH6 7BQ UK
Tel: +44 (0)131 555 0909 Fax: +44 (0)131 555 0909
Email: sales@keyprint.co.uk
Website: www.keyprint.co.uk